

# DOWN DISCHARGE PLENUM

WITH MOTORIZED BACK DRAFT DAMPER INSTALLED

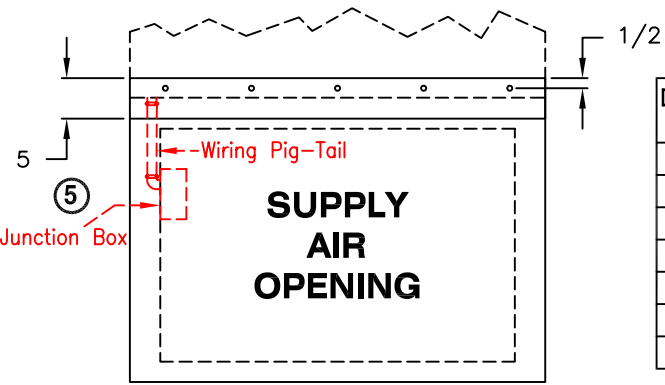

PLENUM SELECTION CHART

DOWN DISCHARGE PLENUM NUMBER	UNIT NUMBER	A	B	WEIGHT (LBS)
DD-1	175/225	41	28 1/2	105
DD-2	300/400	62	35	170
DD-2	600/800	62	35	170
DD-2	900/1200	62	35	170
DD-1	SC1/SE1/SHE1	41	28 1/2	105
DD-1	SC2/SE2/SHE2	41	28 1/2	105
DD-2	DUAL BLOWER	62	49 1/2	170

TOP VIEW

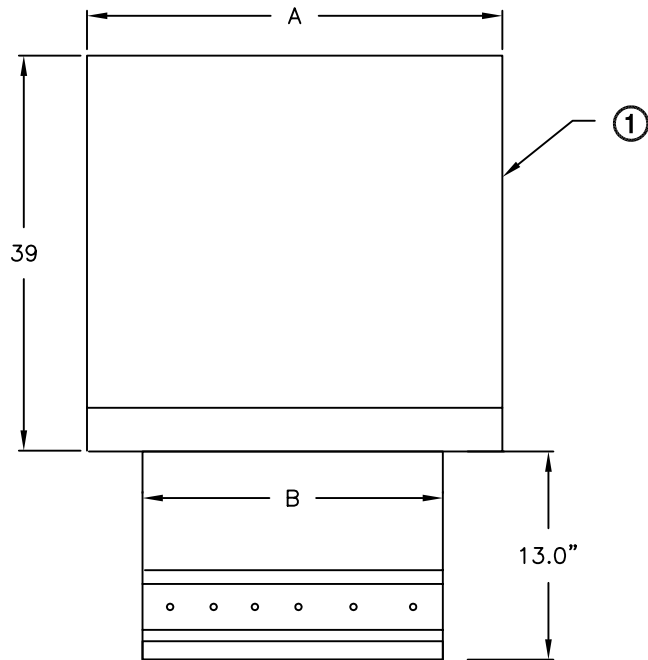

## NOTES:

- ① Plenum Hood Constructed of 20 ga. G90U, Galvanized Finish.
- ② Plenum and Gasket Material shipped separate for field mounting by others.
- ③ Insulated internally with 1"-1 1/2 lbs. Density Matte Faced Fiberglass Insulation.
- ④ 120/1 - 2 Position Damper Motor
- ⑤ Junction box for 120/1 to be wired to pig-tail mounted on discharge of unit. **Field Connections required.**

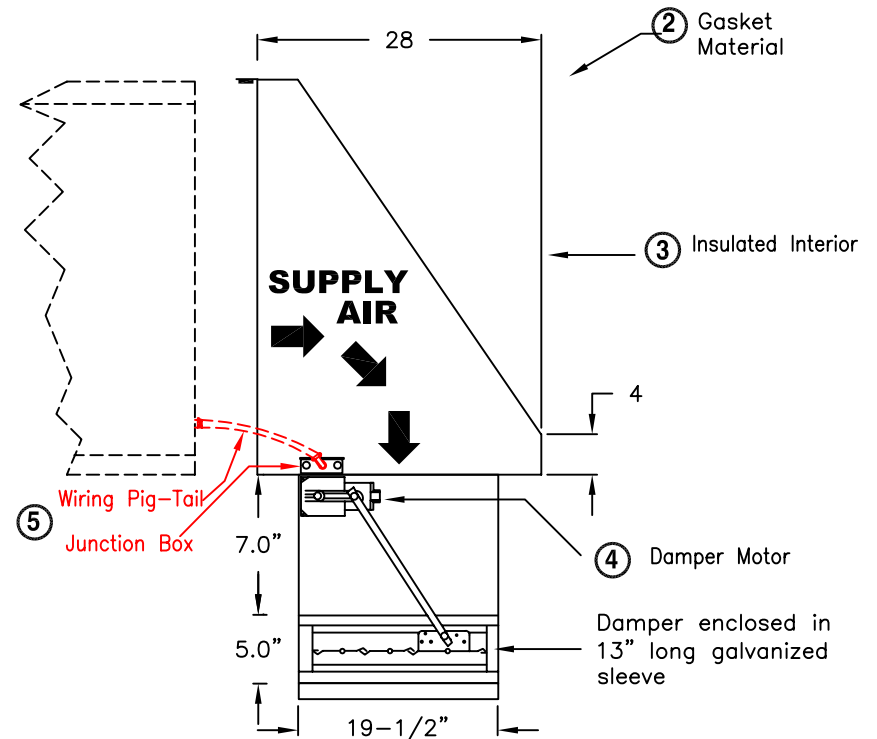

NOTE: All dimensions are in inches.

PROJECT:	LOCATION:	
ENGINEER:	ARCHITECT:	
CONTRACTOR:	DATE:	PAGE: _____ of _____

# ARES

A Division of Mars® Air Products  
 14716 S. BROADWAY ♦ GARDENA, CA 90248  
 Phone: (310) 532-1555 ♦ (800) 421-1266 ♦ Fax: (310) 324-3030